

# A01 SERIES

## INDUSTRIAL CONTROLS

Panel cut-out  $\phi$ 16mm



Page	Contents
2	Distinctive features
3	Specifications
4	Illuminated or non-illuminated Pushbutton Switches
5	Indicators
6	Rotary Lever Switches
7	Keylock Switches
8	Emergency stop Switches and Mushroom Head Pushbuttons
9	Accessories
10	Installation Tools

# A01 SERIES

## INDUSTRIAL CONTROLS

### Distinctive Features

**The A01 Series is designed and manufactured in the united Kingdom**

- pushbutton switches illuminated or not
  - indicators
  - 2 and 3 position keylock switches
  - 2 and 3 position rotary lever switches
  - emergency stop switches
- with rectangular, square or round operators.

- Environmental protection to IP65
- Modular construction
- Electrical life: 50,000 cycles min.
- Screen engraving or insertable legends on request
- Approvals



Sub-assembly

## CE - Marking

### A01 Series

- Panel cut-out: .630" (16mm) dia.
- 1, 2, 3 and 4 poles
- Solder lug/quick connect terminals
- Contacts: silver, gold plated
- Current/voltage rating:  
6A 250 VAC max. - 10 mA 5 VAC min.
- Lamp: filament, neon or multi-chip LED

# A01 SERIES

## INDUSTRIAL CONTROLS

### Specifications

#### ELECTRICAL SPECIFICATIONS

<p><b>Function:</b></p> <p><b>Current/voltage rating:</b></p> <p><b>Contact gap:</b></p> <p><b>Initial contact resistance:</b></p> <p><b>Insulation resistance:</b></p> <p><b>Dielectric strength:</b></p> <p><b>Electrical life:</b></p> <p><b>Insulation:</b></p> <p><b>Lamp life:</b></p>	<p>Momentary or maintained action</p> <p>10 mA 5 VAC min. - 6 A 250 VAC max.</p> <p>1,5mm (.059") double break</p> <p>10 m max. at 1 A 4 VDC</p> <p>50 MΩ min.</p> <p>750 V between open contacts 5KV live to accessible</p> <p>50,000 cycles min.</p> <p>Class 2</p> <p>LED: 60,000 hrs. min. to 75% relative luminosity. Filament: approx 5,000 hrs. Neon: approx. 10,000 hrs.</p>	
--	--	--

#### GENERAL SPECIFICATIONS

<ul style="list-style-type: none"> <li>● <b>Mechanical life (min.):</b></li> <li>● <b>Operating force:</b></li> <li>● <b>Operating temperature:</b></li> <li>● <b>Solder heat resistance:</b> (IEC 68-2-20Tb, method 2):</li> <li>● <b>Operating humidity:</b></li> <li>● <b>Degree of environmental protection (IEC 529)</b></li> <li>● <b>Lamps:</b></li> <li>● <b>Switch terminals:</b></li> <li>● <b>Lamp terminals:</b></li> </ul>	<p>Momentary: 1 million cycles Maintained action: 100,000 cycles</p> <p>2,5N - 10N depending on switch element fitted</p> <p>-20°C to +55°C</p> <p>350°C, 5 seconds</p> <p>Up to 95% RH</p> <p>IP 65 front of panel IP 40 back of panel BS R1A 20</p> <p>Midget grooved T1 3/4, filament, multi-chip LED or neon</p> <p>Solder/quick connect 2.8mm (.110")</p> <p>Solder/quick connect 2.8mm (.110")</p>	
---	--	--

# A01 SERIES

## ILLUMINATED OR NON ILLUMINATED PUSHBUTTON SWITCHES

Panel cut-out  $\phi 16\text{mm}$

**A pushbutton assembly requires:**

Screen + Lamp (if illuminated) + Operator + Switchblock

**Example:** IP65 rectangular pushbutton, single pole, maintained, red screen and 12V red LED = A0161B, A0142M1, A0101X and A0151B

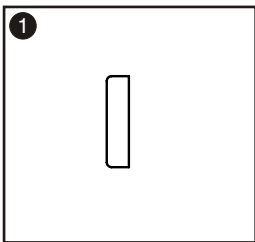
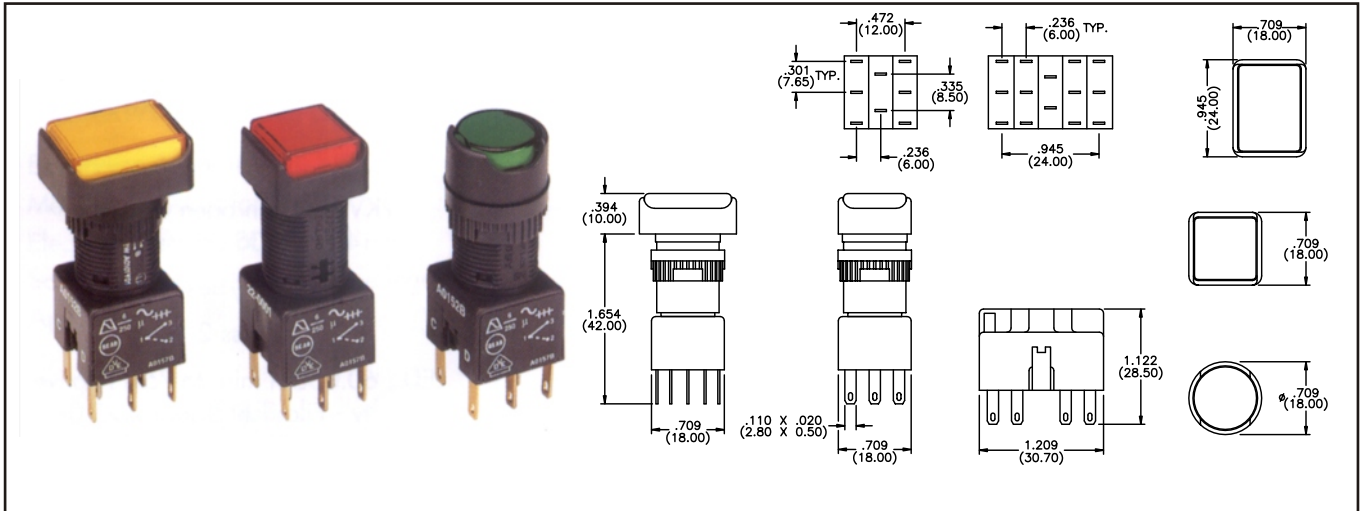
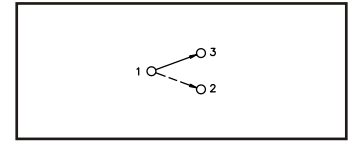

SCREEN

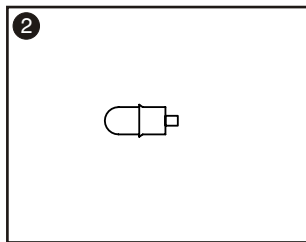

LAMP

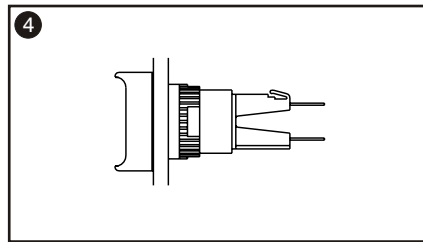

OPERATOR

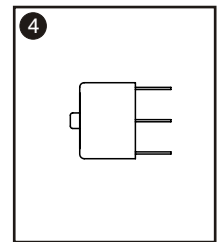

SWITCH BLOCK

# A01 SERIES

## INDICATORS

Panel cut-out  $\phi 16\text{mm}$

**An indicator assembly requires:**

Screen + Lamp + Operator

**Example:** IP65 rectangular indicator with red screen and 12V red LED =  
A0161B, A0142M1 and A0171

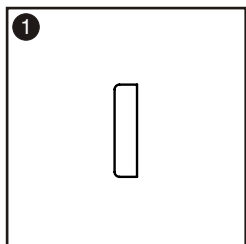
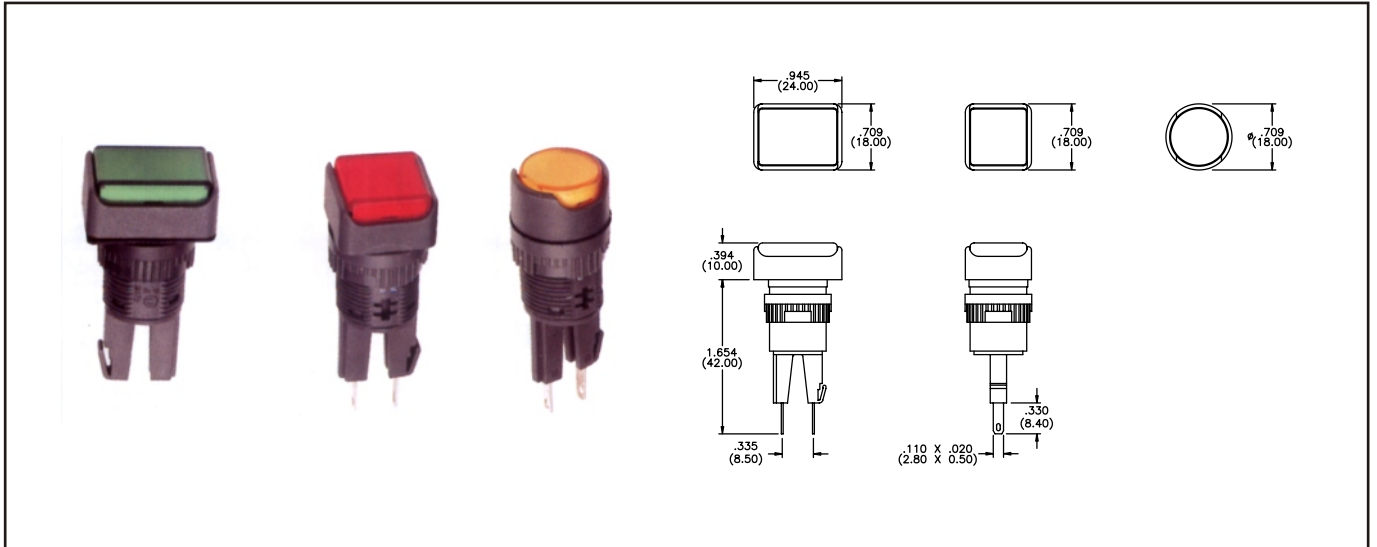

SCREEN

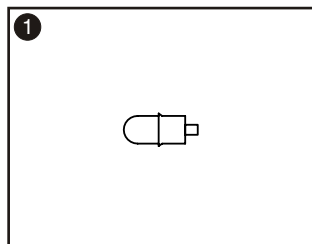

LAMP

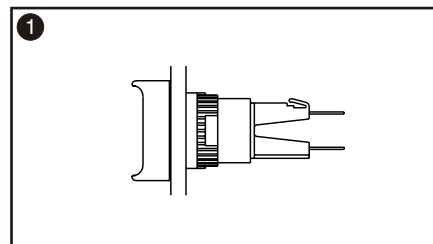

OPERATOR

# A01 SERIES

## ROTARY LEVER SWITCHES

### Panel cut-out $\phi 16\text{mm}$

**A rotary lever switch assembly requires:**

Operator + Switchblock

Example: IP65 rectangular rotary switch with long lever, single pole, 2 positions maintained = A019101 and A0151B

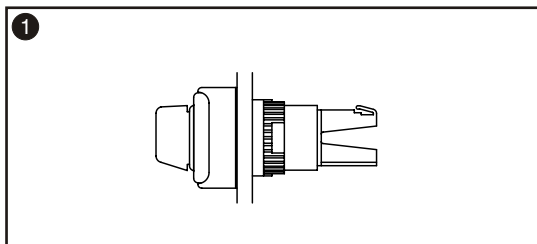
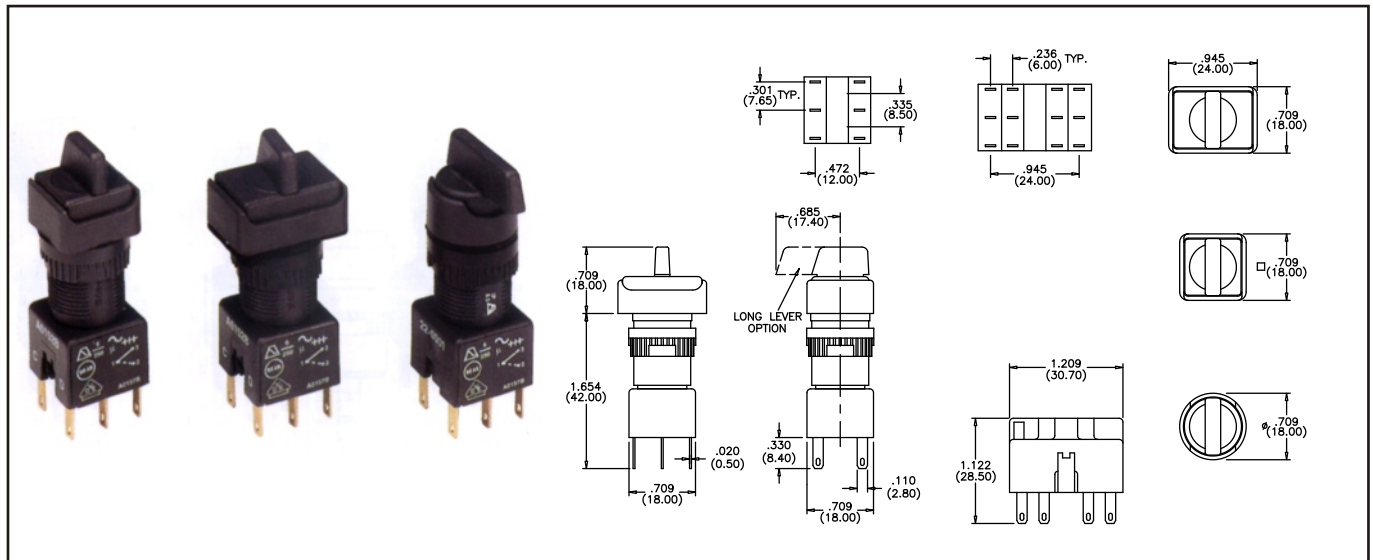
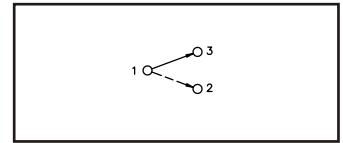

**OPERATOR**

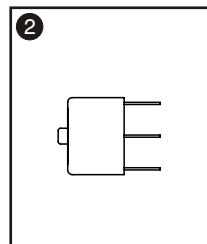

**SWITCH BLOCK**

**LEVER POSITIONS**

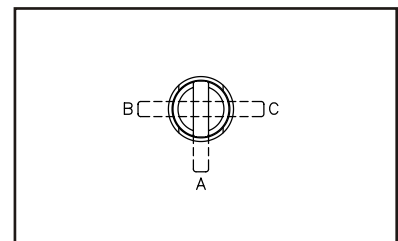

**Lever rotation - 2 position switches**

The model numbers shown are for switches with anticlockwise lever rotation. For clockwise rotation, replace:

- 01** with **09**
- 02** with **10**
- 03** with **11**
- 04** with **12**

at the end of the model number.

# A01 SERIES

## KEYLOCK SWITCHES

Panel cut-out  $\phi 16\text{mm}$

**A keylock switch assembly requires:**

Operator + Switchblock

**Example:** Rectangular keylock switch, single pole, 2 positions maintained = A018101 and A0151B

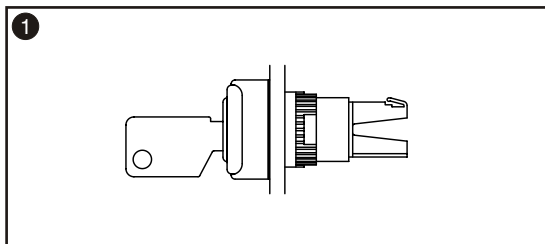
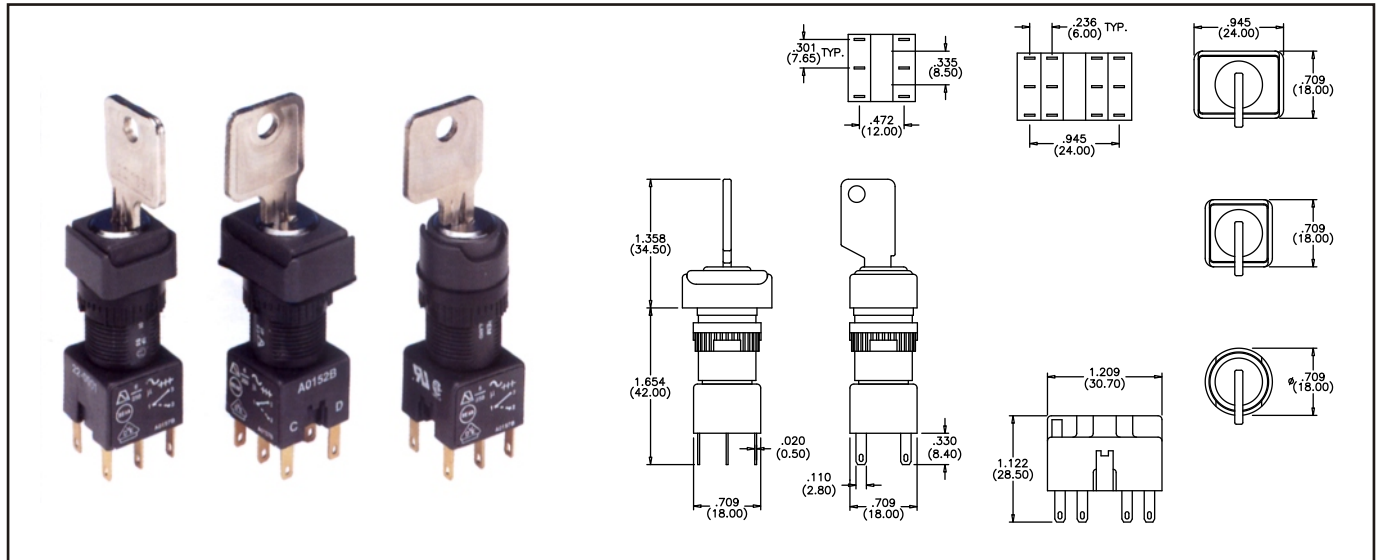
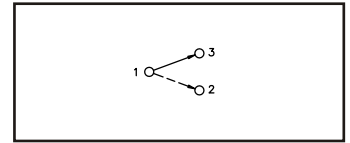

OPERATOR

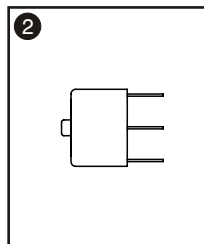

SWITCH BLOCK

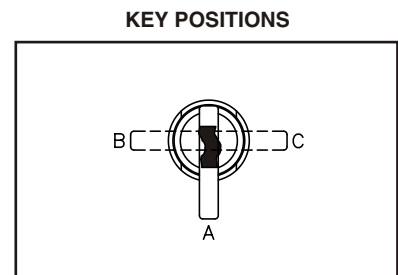

**Key rotation - 2 position switches**

The model numbers shown are for switches with counterclockwise key rotation. For clockwise rotation, replace:

- 01 with 25
- 02 with 24
- 03 with 27
- 04 with 28

at the end of model number.

2 standard keys are supplied.  
20 key barrel types available from stock.

# A01 SERIES

## EMERGENCY STOP SWITCHES AND MUSHROOM HEAD PUSHBUTTONS Panel cut-out $\phi 16\text{mm}$

- Prominent  $\phi 24\text{mm}$  (.944) dia. red mushroom actuator
- Highly reliable positive break switch
- Push to shut switch 'off', twist to reset to 'on'

An emergency stop switch assembly requires: Operator + Switch block  
APPROVED TO UL1054/EN 60947

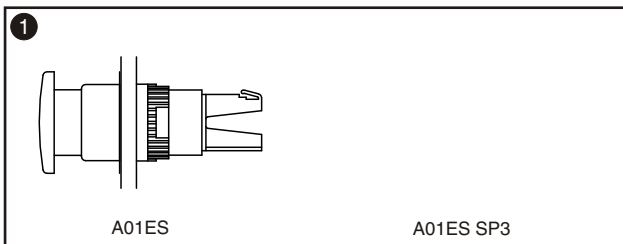
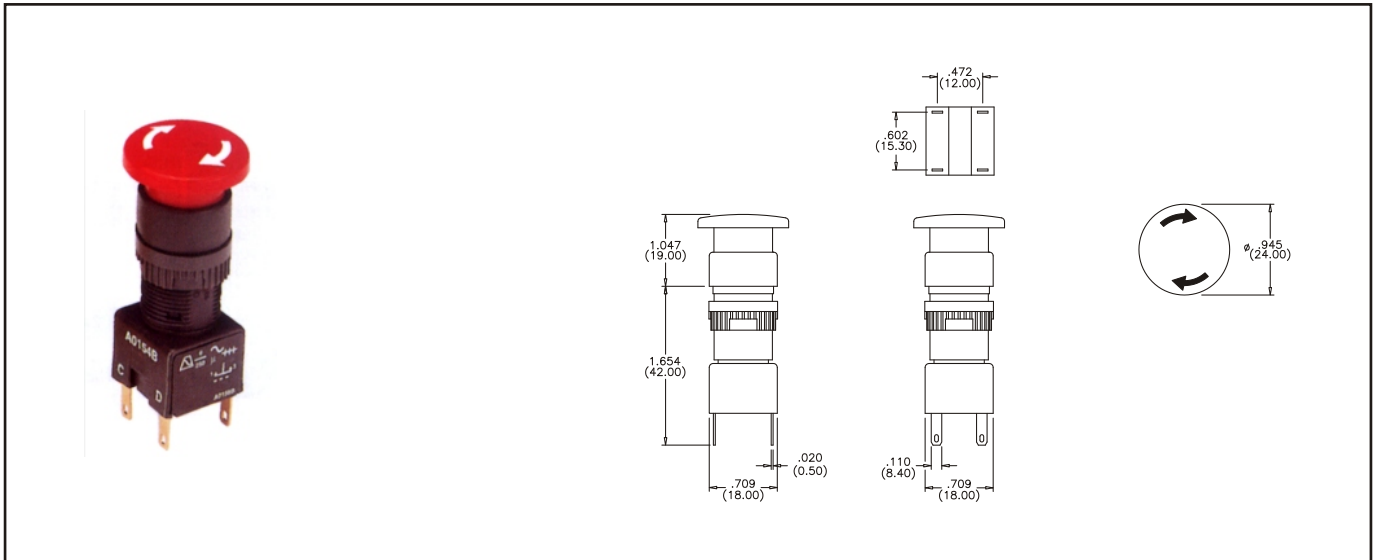
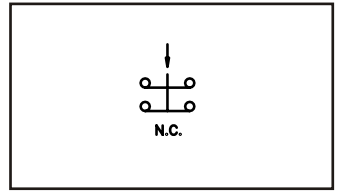

**OPERATOR**

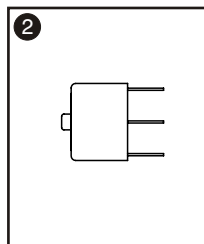

**SWITCH BLOCK**



**$\phi 60\text{mm}$  SELF ADHESIVE LABEL**

# A01 SERIES

## ACCESSORIES

### PCB SOCKET

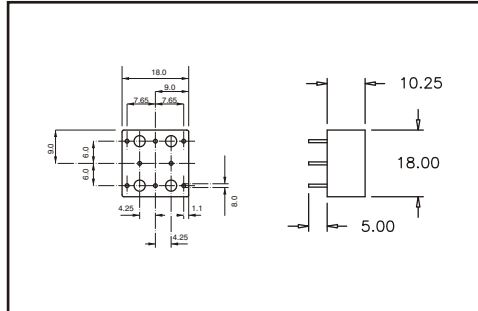
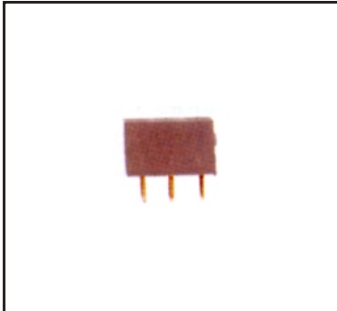

Single pole, non illuminated  
 Double pole, non illuminated  
 Single pole, illuminated  
 Double pole, illuminated  
 Indicator

### FLAPGUARDS

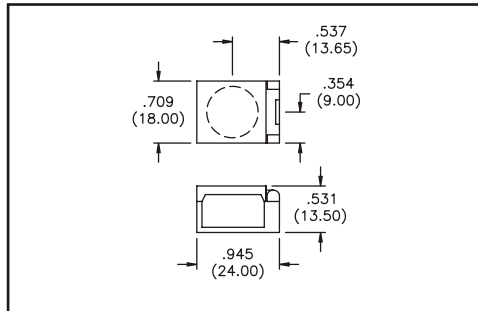

Rectangular bezel  
 Round/square bezel

### FLUSH MOUNTING BEZELS

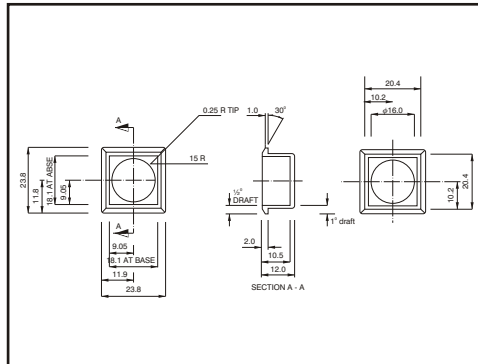

Rectangular bezel  
 Round/square bezel  
 Rectangular washer  
 Round/square washer

### METAL GUARDS

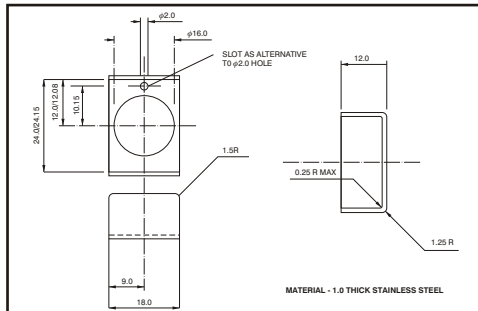

Rectangular bezel  
 Round/square bezel

### ANTI-ROTATION RING

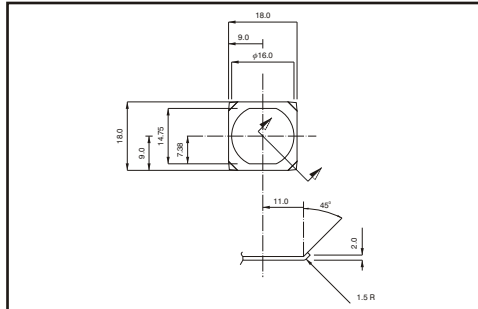
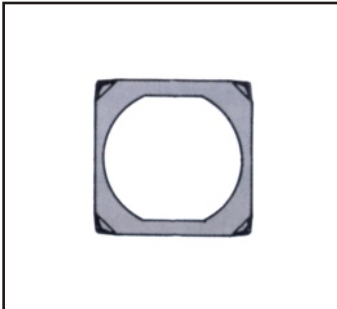

Lock washer

# A01 SERIES

## INDUSTRIAL CONTROLS

### Installation Tools

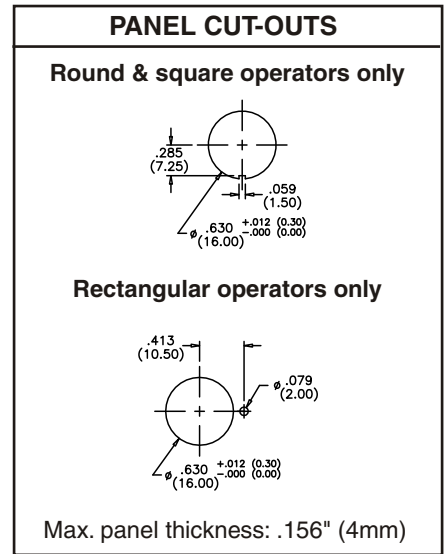
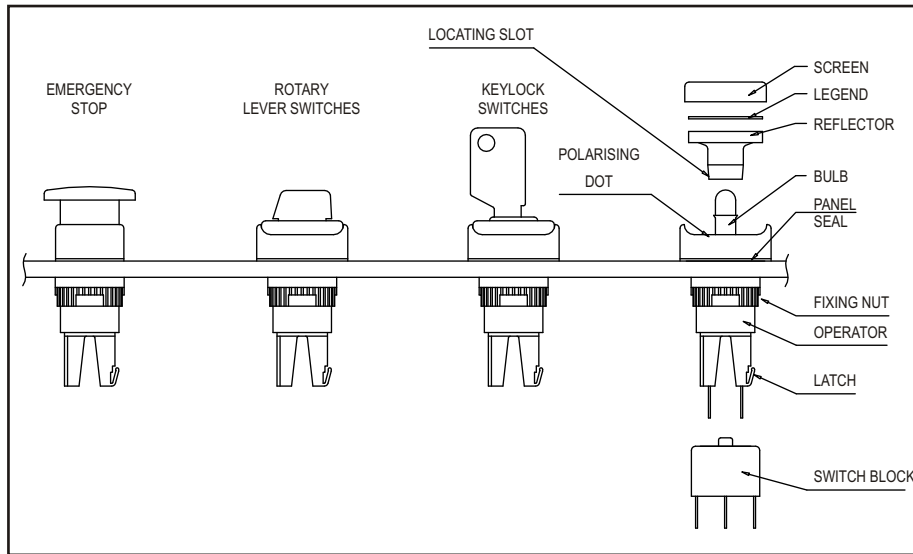

#### PANEL MOUNTING ASSEMBLY

- Drill/punch hole shaped as above.
- Assemble front operator through hole, fit fixing nut and tighten to a maximum torque of 0.8Nm using tool No. 30-0001.
- Wire chosen switch block as required and slide onto operator until latch engages.
- Fit bulb if required using tool No. 30-0002.
- Snap screen onto reflector assembly with legend in between if required and snap onto front operator **TAKING CARE TO LINE UP THE LOCATING SLOT WITH THE POLARISING DOT**, and not to damage the seal.

#### TO REMOVE BULB

Remove reflector/screen assembly by inserting tool No. 30-0006 between the bezel finger guard and the screen to engage the slot and pulling. Use the bulb extractor to remove the bulb.

#### SWITCH BLOCK

To assemble switch block to front operator, firstly, **TAKE CARE TO LINE UP SWITCH BLOCK WITH FRONT OPERATOR**. Once in position slide on to front operator. N.B. Ensure latch is fully engaged correctly onto the switch block.

To remove switch block, depress the latch and slide the switch block off the operator.

